



**SWIF *TEN* RACKING SYSTEM
DATA SHEETS**

SWIF Solar LLC
866 N Columbia Blvd.
Building D-3
Portland, OR 97217
MAIN: (541) 490-0536
INFO@SWIFSolar.com
SUPPORT@SWIFSolar.com
SALES@SWIFSolar.com

SWIF *TEN* RACKING SYSTEM RAIL DATA SHEET

MATERIALS + FABRICATION

- Hot Rolled Steel, 55 KSI. Conforms to ASTM A653.
- G90 Galvanized Coating Resists Corrosion.
- Custom Lengths Fabricated for Each Project.

PART # [DDGGSR]*	D (in)	G (gauge)	B (in)	LIP (in)	Ixx (in4)	AREA (in2)	SHARED RAIL
0616	06	16	2.5	0.69	4.13	0.72	NO
0616SR	06	16	2.5	0.69	4.13	0.72	YES
0614	06	14	2.5	0.72	5.14	0.9	NO
0614SR	06	14	2.5	0.72	5.14	0.9	YES
0814	08	14	2.5	0.78	10.15	1.06	NO
0814SR	08	14	2.5	0.78	10.15	1.06	YES
0812	08	12	2.5	0.83	14.09	1.48	NO
0812SR	08	12	2.5	0.83	14.09	1.48	YES

*SR indicates a SHARED RAIL (RAIL C) format with 5/16" holes every 3" along the top leg of the RAIL.

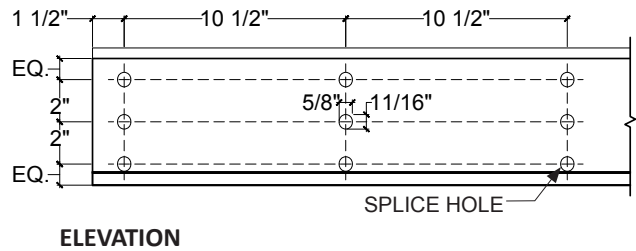
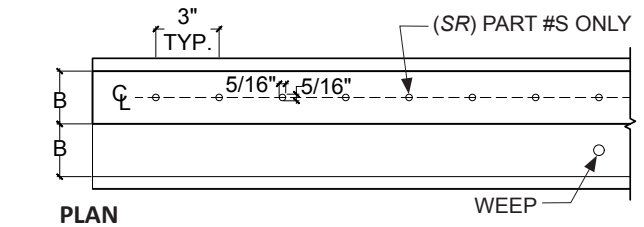
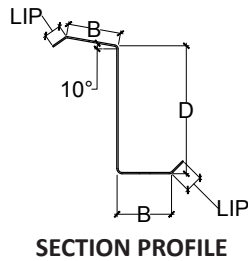

PART # [DDGGSR]*	D (in)	G (gauge)	B (in)	LIP (in)	Ixx (in4)	AREA (in2)	SHARED RAIL
1014	10	14	3	0.78	19.08	1.28	NO
1014SR	10	14	3	0.78	19.08	1.28	YES
1012	10	12	4	0.83	31.69	2.01	NO
1012SR	10	12	4	0.83	31.69	2.01	YES
1212	12	12	4	0.99	48.39	2.22	NO
1212SR	12	12	4	0.99	48.39	2.22	YES

*SR indicates a SHARED RAIL (RAIL C) format with 5/16" holes every 3" along the top leg of the RAIL.

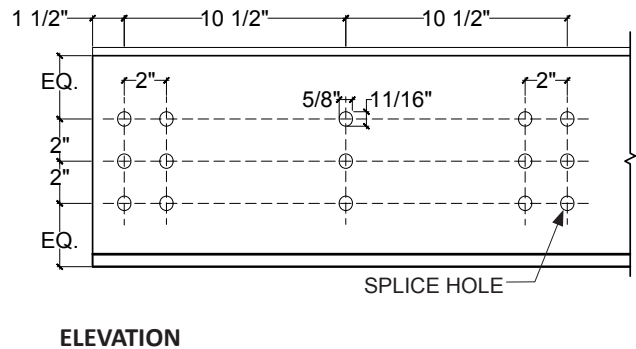
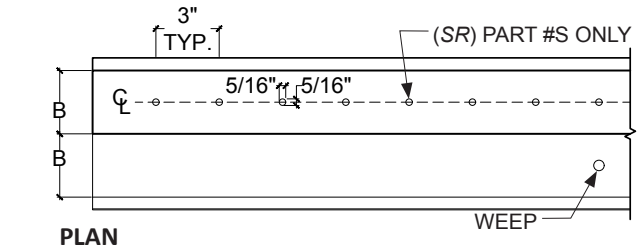
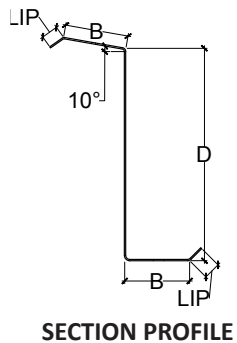

SWIF *TEN* RACKING SYSTEM

SWIF DATA SHEET

MATERIALS + FABRICATION

- Pipe Steel, 35 KSI. Conforms to ASTM A53.
- Plate Steel, 36 KSI. Conforms to ASTM A36.
- Hot Dip G90 Galvanized Coating Resists Corrosion. Conforms to ASTM A-123 / ASTM A-153.
- Custom Foot Configurations + SWIF-to-Roof Fastener Types for different building structure types.

SWIF WOOD FRAMING (WF) SCHEDULE				
<i>(Designed for 1/4" Φ Simpson SDS screw w/ 1 1/2" min. Penetration into Joist)</i>				
PART #	PIPE I.D.	"L" Plate	"t" Plate	N (screws)
[##_XX_##]*	(in)	(in)	(in)	(#)
20_WF_36/45/48/60	2" Std.	15	3/8	6
25_WF_36/45/48/60	2 1/2" Std.	18	3/8	8
30_WF_36/45/48/60	3" Std.	22	1/2	10
35_WF_36/45/48/60	3 1/2" Std.	25	5/8	12

SWIF LIGHT GAUGE PURLIN (LGP) SCHEDULE				
<i>(Designed for 1/4" Φ SMS into 16 gauge Minimum Purlin)</i>				
PART #	PIPE I.D.	"L" Plate	"t" Plate	N (screws)
[##_XXX_##]*	(in)	(in)	(in)	(#)
20_LGP_36/45/48/60	2" Std.	18	3/8	8
25_LGP_36/45/48/60	2 1/2" Std.	21	1/2	10
30_LGP_36/45/48/60	3" Std.	25	5/8	12
35_LGP_36/45/48/60	3 1/2" Std.	28	5/8	14

*Part Number Format: ##_XX or XXX_##
PIPE I.D. (inches)_ROOF STRUCTURE TYPE_SWIF HEIGHT (inches)

SWIF WOOD DECKING (WD) SCHEDULE				
<i>(Designed for 1/4" Φ Simpson SDS)</i>				
SWIF CONCRETE DECKING (CD) SCHEDULE				
<i>(Designed for 1/4" Φ Titen Turbo)</i>				
PART #	PIPE I.D.	"L" Plate	"t" Plate	N (screws)
[##_XX_##]*	(in)	(in)	(in)	(#)
20_WD/CD_36/45/48/60	2" Std.	12	3/16	12
25_WD/CD_36/45/48/60	2 1/2" Std.	12	3/16	12
30_WD/CD_36/45/48/60	3" Std.	15	1/4	24
35_WD/CD_36/45/48/60	3 1/2" Std.	15	1/4	24

*Part Number Format: ##_XX_##
PIPE I.D. (inches)_ROOF STRUCTURE TYPE_SWIF HEIGHT (inches)

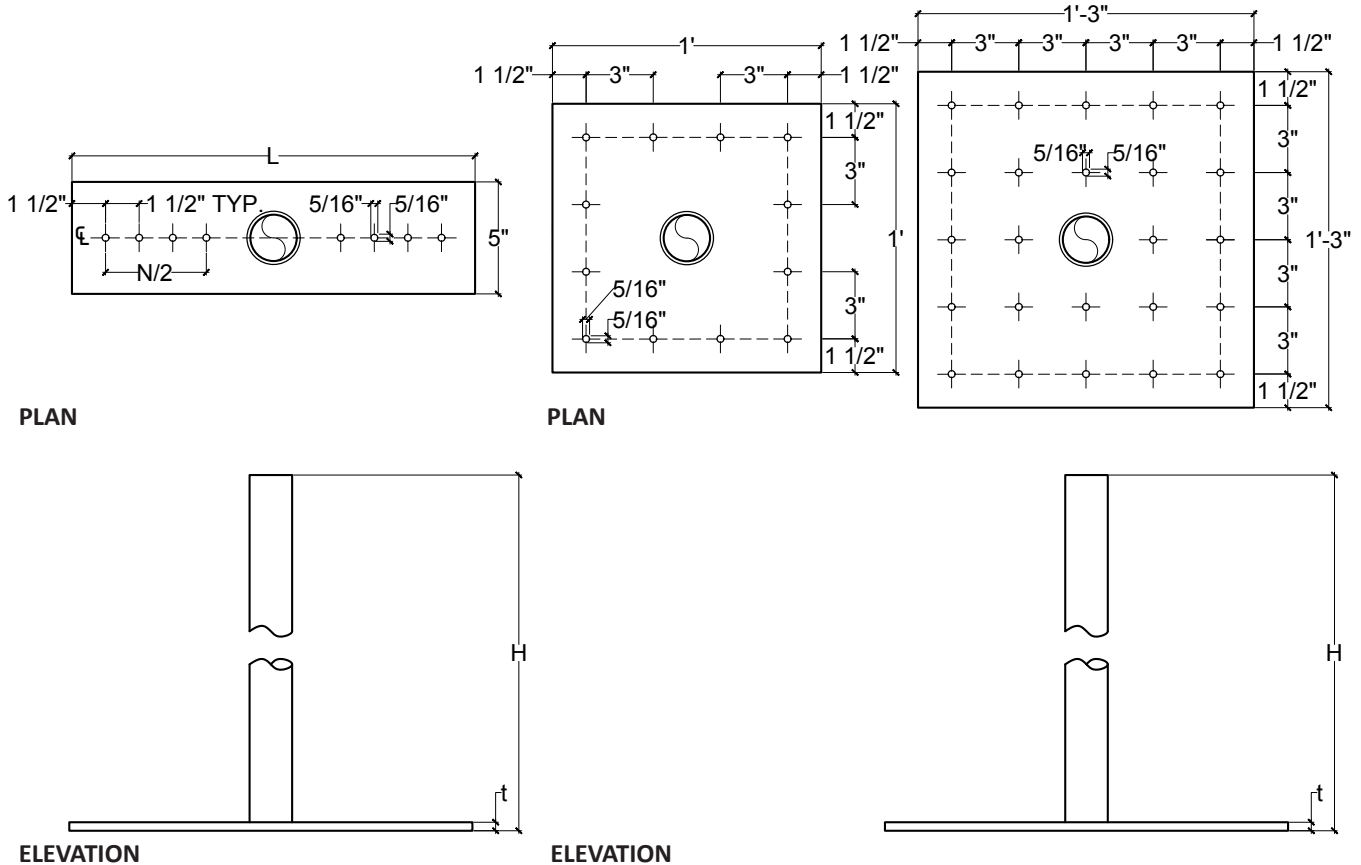

SWIF *TEN* RACKING SYSTEM HARDWARE DATA SHEET

MIDCLAMP ASSEMBLY

- 316 Stainless Steel
- Bond Modules + RAILS
- MIDCLAMP ASSEMBLY Carriage Bolt Detail Resists Rotation for Simple Install

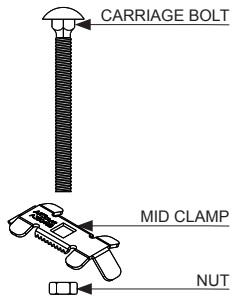

MIDCLAMP ASSEMBLY SCHEDULE		
PART # [M##]	PV FRAME DEPTH (mm)	FASTENER LENGTH (in)
M20	< 40	2.0
M25	40 - 49	2.5
M30	50 (+)	3.0

Additional fastener lengths may be available upon request.

ENDCLAMP ASSEMBLY

- 316 Stainless Steel
- Bond Modules + RAILS
- ENDCLAMP ASSEMBLY Offered in Multiple Sizes to Accommodate Different Module Frames

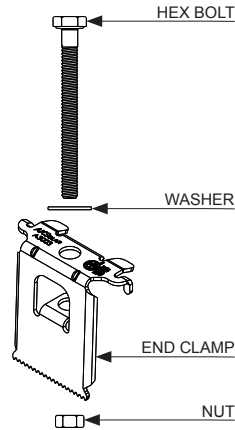

ENDCLAMP ASSEMBLY SCHEDULE		
PART # [E##_##]	PV FRAME DEPTH (mm)	FASTENER LENGTH (in)
E30_20	30	2.0
E35_20	35	2.0
E40_25	40	2.5
E45_25	45	2.5
E50_30	50	3.0

Additional fastener lengths may be available upon request.

SELF DRILLING BOLT

PART # TKS1420

- RAIL to SWIF Fastener
- ASTM B117 Corrosion - Resistant Finish
- TEKS 4 Drill Point

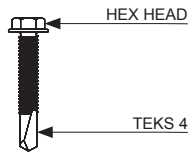

SPLICE BOLT

PART # SB05

- RAIL to RAIL SPLICE Fastener
- 316 Stainless Steel

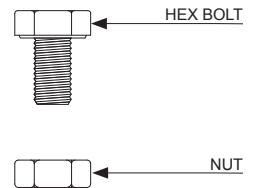

GROUNDING LUG

PART # AH010

- Includes All Hardware
- Accepts 4-12 AWG Solid Copper Conductors

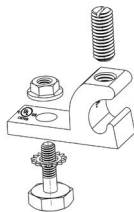

SWIF CAP

- Ribbed Secure Fit

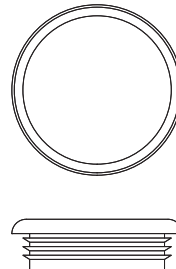

SWIF CAP SCHEDULE	
PART # [SC_##]	SWIF LEG ID (in)
SC_20	2.0
SC_25	2.5
SC_30	3.0
SC_35	3.5